

# Benewah County Fire Protection Districts Map Book

## Township 47 North, Range 03 & 04 West

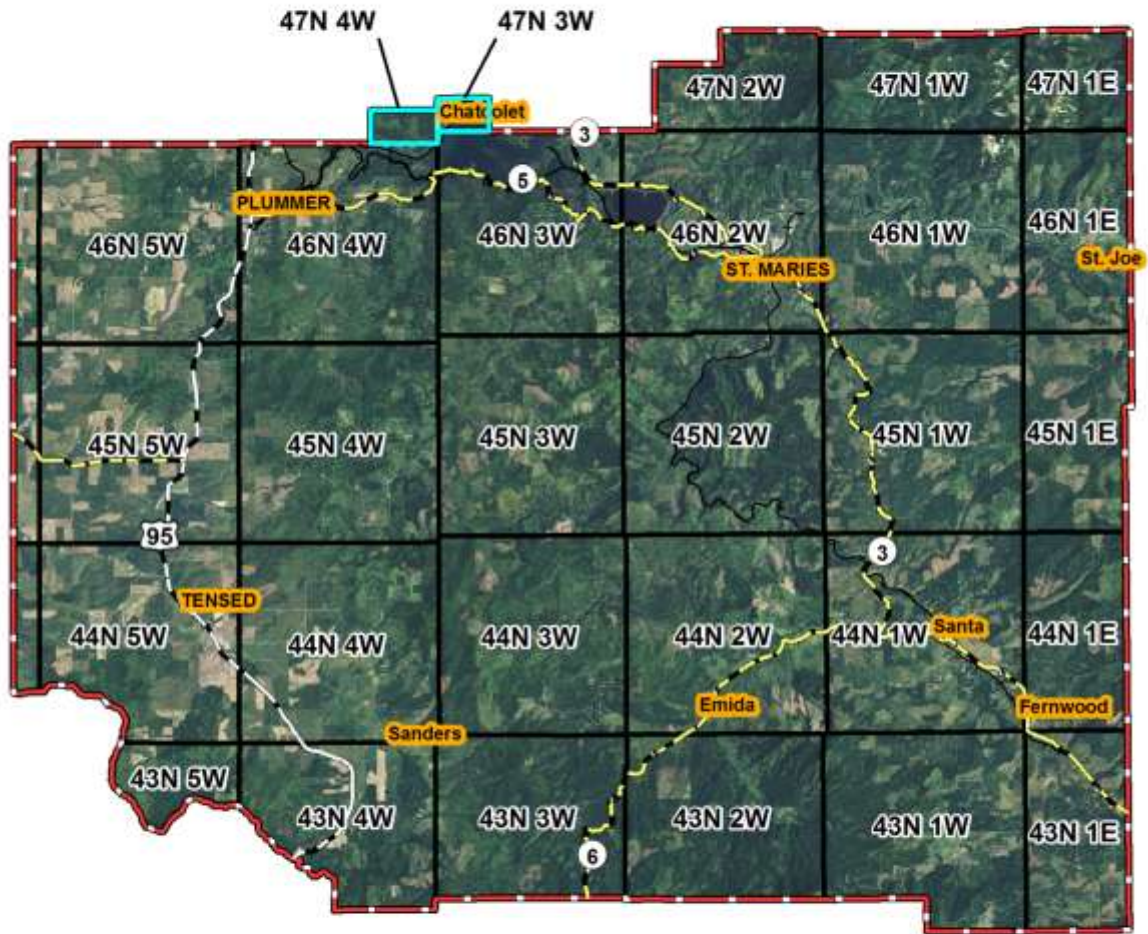

**Kamiak  
Geospatial**

Print Date: July 1, 2012

Projection: NAD 83 UTM11N  
(C) 2012 Kamiak Ridge, LLC  
& Benewah County



- |                            |                           |
|----------------------------|---------------------------|
| <b>INCORPORATED CITY</b>   | <b>Boundary</b>           |
| <b>Unincorporated Town</b> | Benewah County            |
| <b>Subdivisions</b>        | Coeur d'Alene Reservation |
| <b>Transportation</b>      | Public Land Survey System |
| U.S. Highway               | Township and Range        |
| State Highway              |                           |
| Railroad                   |                           |

## **Data Sources:**

- Cadastral Data:** - Benewah County Assessor's Office
- Public Land Survey System Data:** - United States Bureau of Land Management  
[http://www.blm.gov/id/st/en/prog/geographic\\_sciences.html](http://www.blm.gov/id/st/en/prog/geographic_sciences.html)
- Political Boundaries:** - United States Department of Agriculture, Natural Resources Conservation Service
- Coeur d'Alene Tribe GIS Department
- [www.InsideIdaho.org](http://www.InsideIdaho.org)
- Fire Protection Districts:** - Benewah County Emergency Management
- Transportation:** - [www.InsideIdaho.org](http://www.InsideIdaho.org)
- Hydrologic:** - Kamiak Ridge, LLC
- ESRI world services data
- Structures:** - Kamiak Ridge, LLC
- Aerial Imagery:** - USDA-FSA Aerial Photography Field Office (2011)

# Benewah County Rural Fire Protection Districts Township 47 North, Range 03 & 04 West

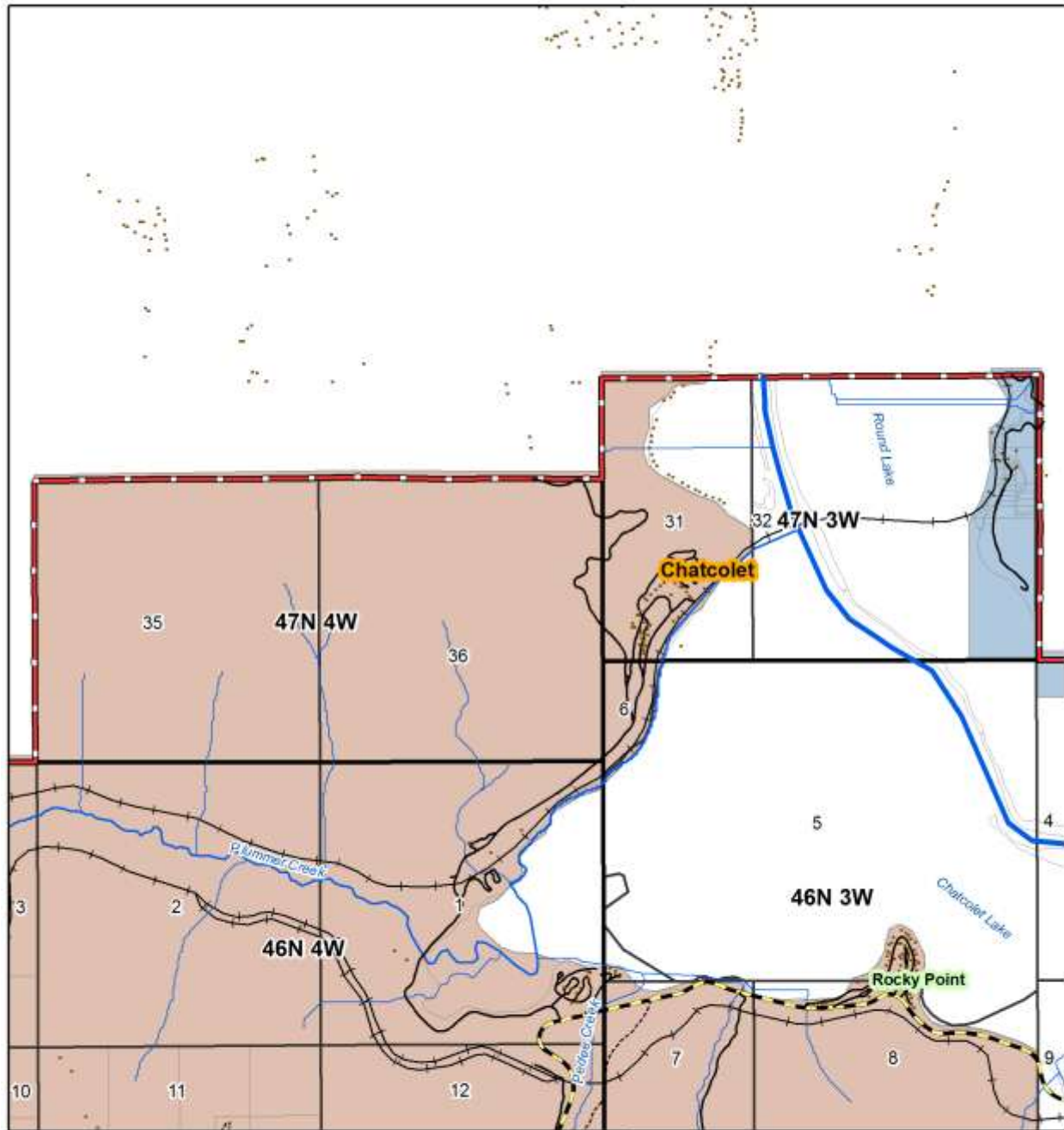

Projection: NAD 83 UTM11N  
(C) 2012 Kamiak Ridge, LLC  
& Benewah County



0 0.5 Miles



<b>INCORPORATED CITY</b>	<b>Boundary</b>	<b>Rural Fire Protection District</b>
<b>Unincorporated Town</b>	Benewah County	Emida Fire
<b>Subdivisions</b>	Coeur d'Alene Reservation	Fernwood Fire
Structures	Public Land Survey System	Gateway Fire
<b>Transportation</b>	Township and Range	St. Maries Fire
U.S. Highway	Section	Tensed Fire
State Highway	Parcels	No Fire Protection
Local Road		
Seasonal Road		
Railroad		

# Benewah County Wildland Fire Protection Districts Township 47 North, Range 03 & 04 West

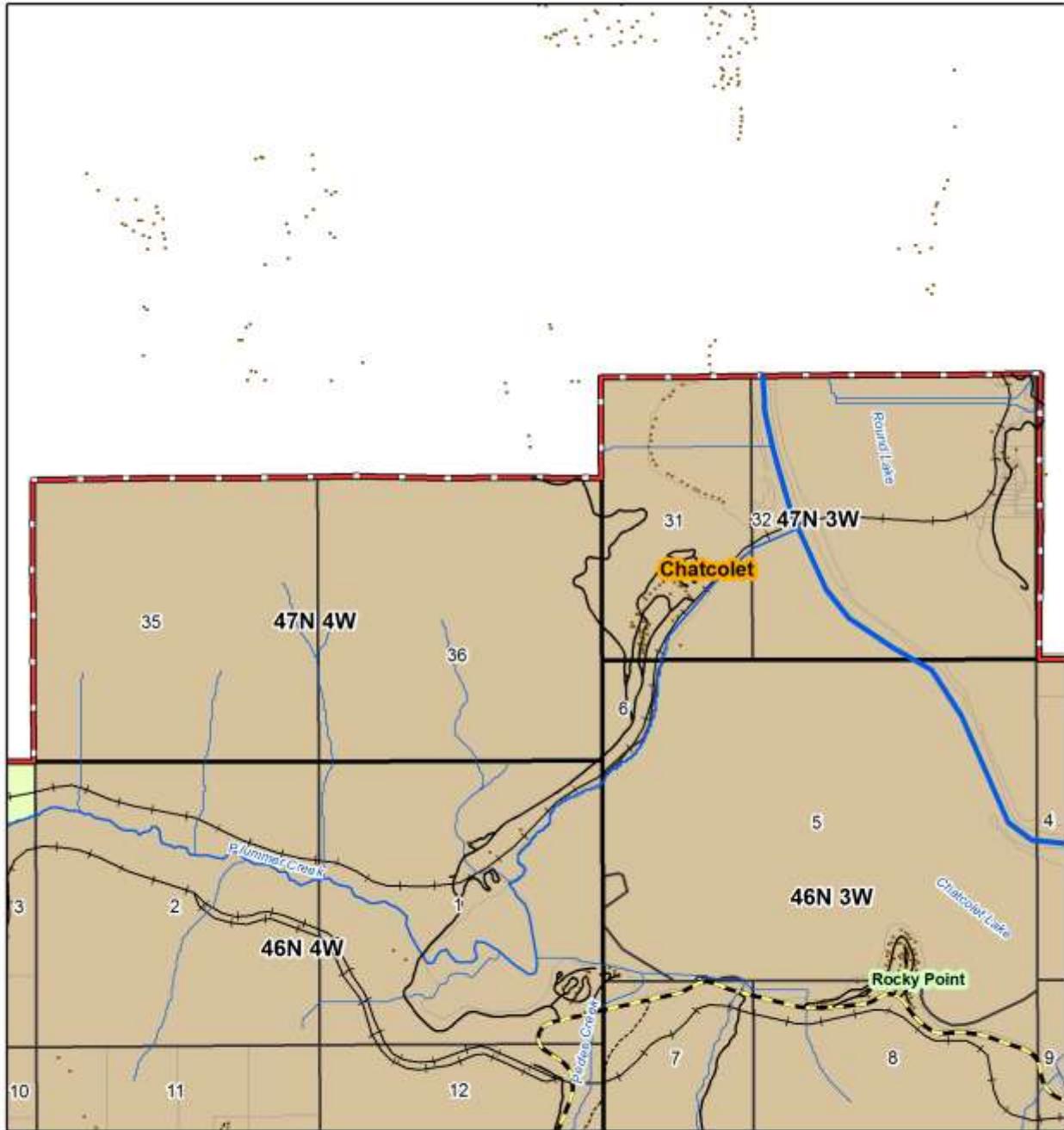

Projection: NAD 83 UTM11N  
(C) 2012 Kamiak Ridge, LLC  
& Benewah County



<b>INCORPORATED CITY</b>	<b>Boundary</b>	<b>Wildfire Protection District</b>
<b>Unincorporated Town</b>	Benewah County	IDL Cataldo
<b>Subdivisions</b>	Coeur d'Alene Reservation	Coeur d'Alene Tribe
<b>Transportation</b>	<b>Public Land Survey System</b>	IDL Ponderosa
Structures	Township and Range	IDL West St. Joe
U.S. Highway	Section	
State Highway	Parcels	
Local Road		
Seasonal Road		
Railroad		

# Benewah County Aerial Imagery

## Township 47 North, Range 03 West, Section 31



Projection: NAD 83 UTM11N  
(C) 2012 Kamiak Ridge, LLC  
& Benewah County

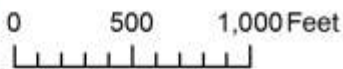

Boundary		Public Land Survey System	
Benewah County	Section	Parcel Boundary	
Coeur d'Alene Reservation			

# Benewah County Property Ownership

## Township 47 North, Range 03 West, Section 31

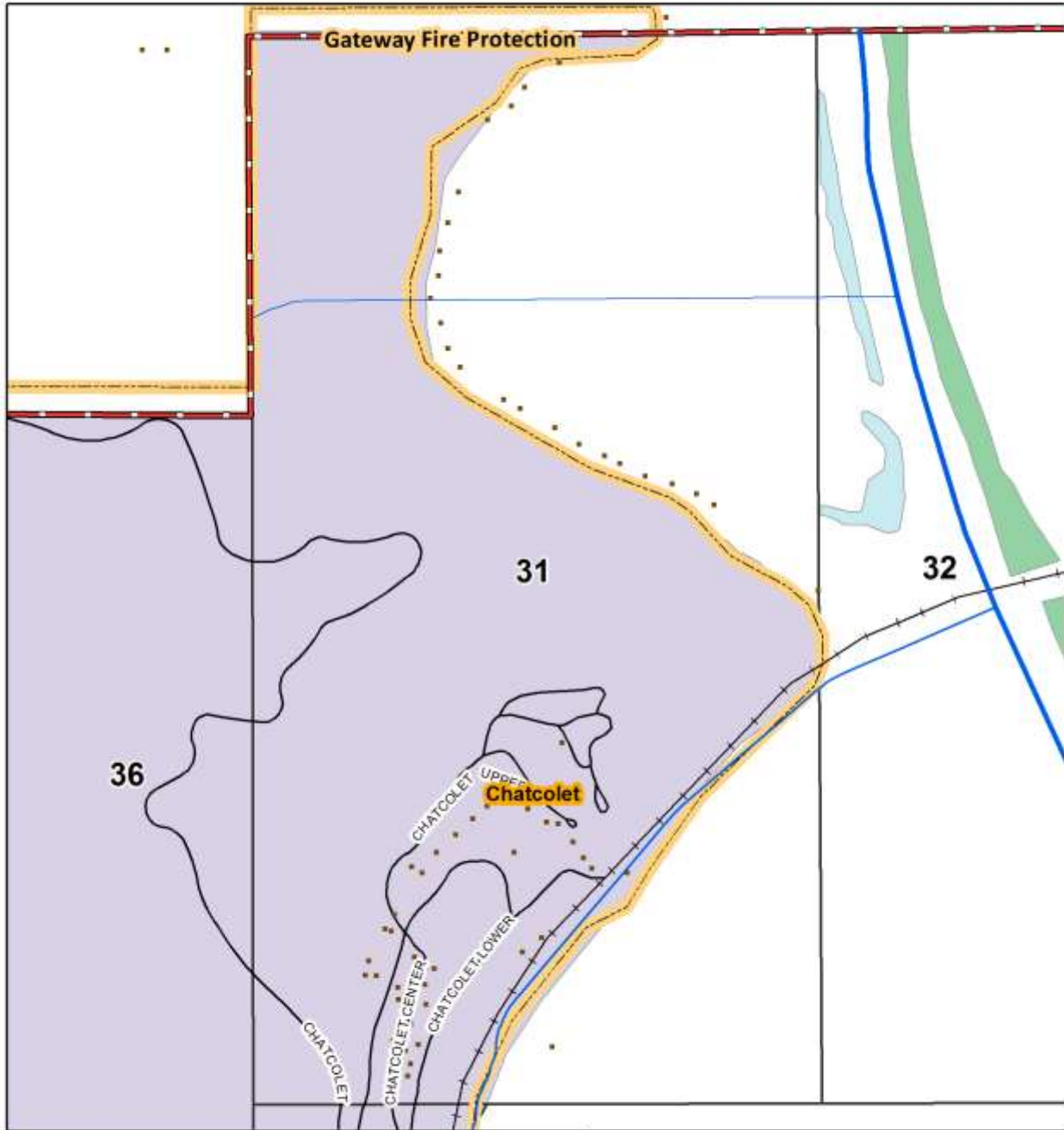

Projection: NAD 83 UTM11N  
 (C) 2012 Kamiak Ridge, LLC  
 & Benewah County

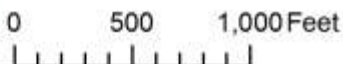

Transportation		Land Ownership	
U.S. Highway	Bureau of Land Management	Public	County
State Highway	US Forest Service	City	School District
Local Road	Bureau of Indian Affairs	Plummer Hwy District	Forest Industry
Seasonal Road	Coeur d'Alene Tribe	Private	No Data
Railroad	Federal (TAP)	Unpatented	Vacated
Boundary	Idaho Department of Lands		
Benewah County	Idaho Transportation Dept.		
Coeur d'Alene Reservation	Idaho Fish and Game		
Public Land Survey System	Idaho Parks & Rec		
Section			

# Benewah County Aerial Imagery

## Township 47 North, Range 03 West, Section 32

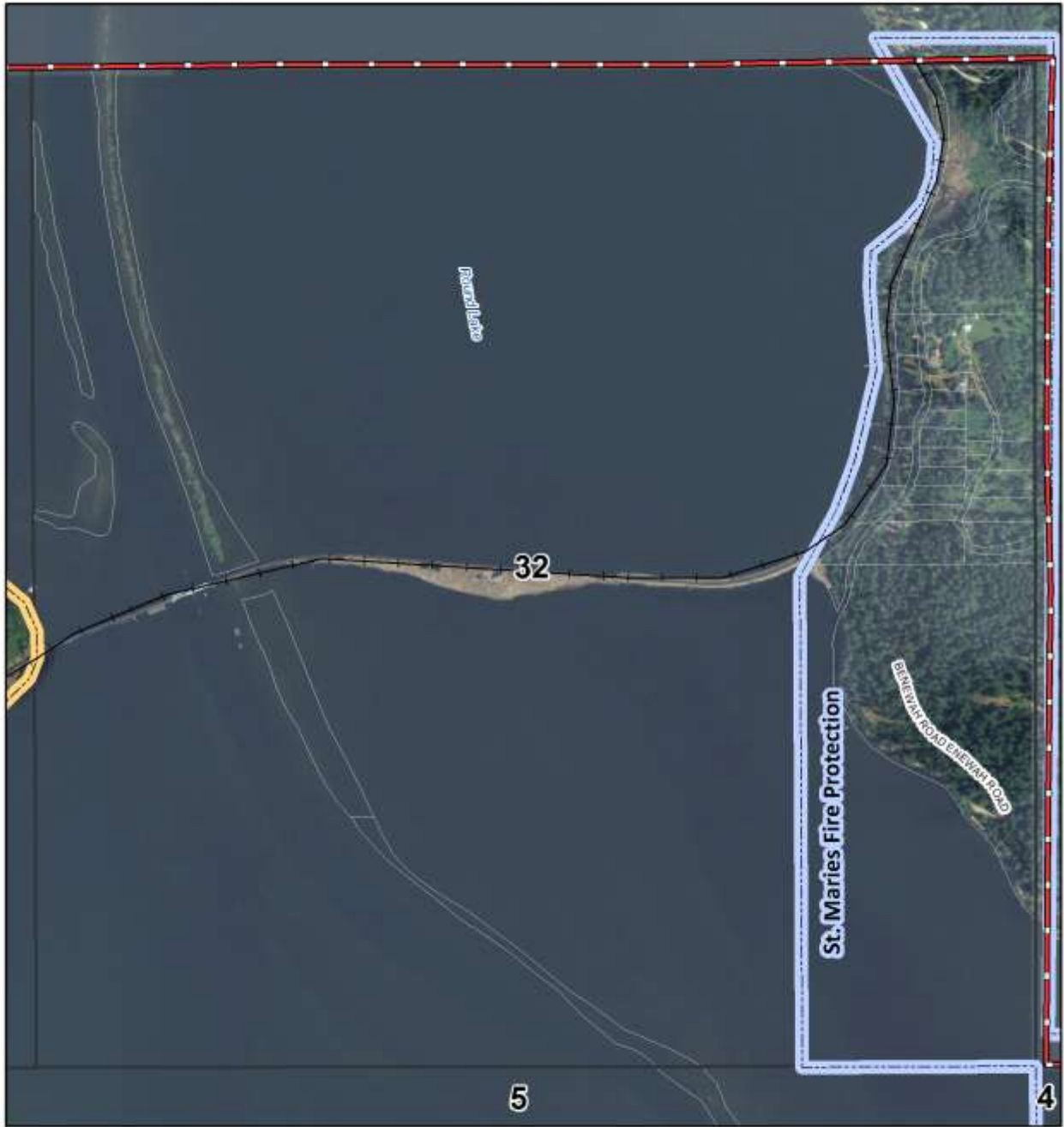

Projection: NAD 83 UTM11N  
(C) 2012 Kamiak Ridge, LLC  
& Benewah County

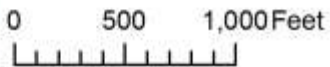

Boundary		Public Land Survey System	
Benewah County	Section	Coeur d'Alene Reservation	Parcel Boundary

# Benewah County Property Ownership

## Township 47 North, Range 03 West, Section 32

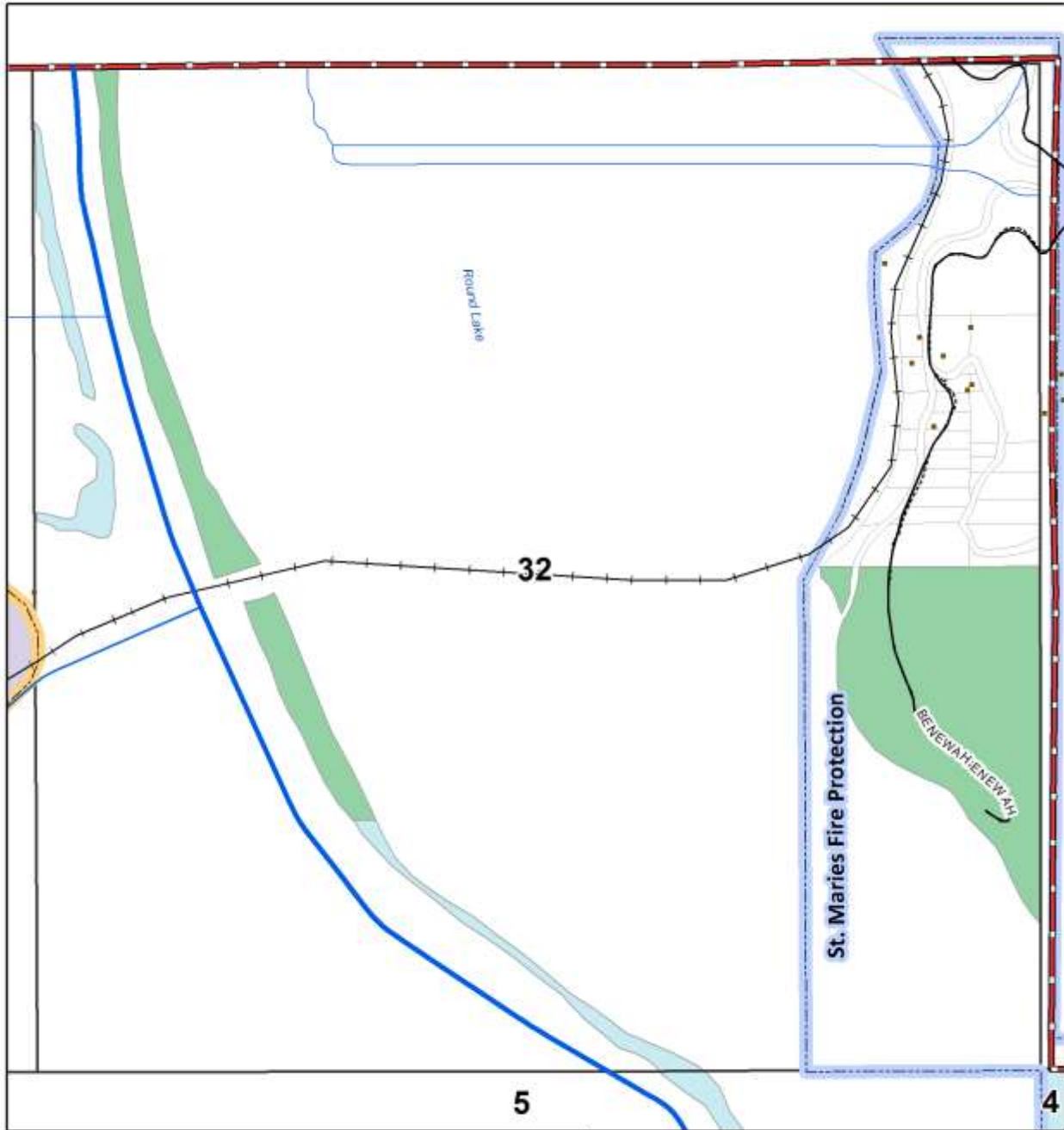

Projection: NAD 83 UTM11N  
 (C) 2012 Kamiak Ridge, LLC  
 & Benewah County



0 500 1,000 Feet



<ul style="list-style-type: none"> <li>• Structures</li> <li>Transportation                             <ul style="list-style-type: none"> <li>U.S. Highway</li> <li>State Highway</li> <li>Local Road</li> <li>Seasonal Road</li> <li>Railroad</li> </ul> </li> <li>Boundary                             <ul style="list-style-type: none"> <li>Benewah County</li> <li>Coeur d'Alene Reservation</li> <li>Public Land Survey System</li> <li>Section</li> </ul> </li> </ul>	<b>Land Ownership</b> <ul style="list-style-type: none"> <li>Bureau of Land Management</li> <li>US Forest Service</li> <li>Bureau of Indian Affairs</li> <li>Coeur d'Alene Tribe</li> <li>Federal (TAP)</li> <li>Idaho Department of Lands</li> <li>Idaho Transportation Dept.</li> <li>Idaho Fish and Game</li> <li>Idaho Parks &amp; Rec</li> </ul>	<ul style="list-style-type: none"> <li>Public                             <ul style="list-style-type: none"> <li>County</li> <li>City</li> <li>School District</li> <li>Plummer Hwy District</li> <li>Forest Industry</li> <li>Private</li> <li>No Data</li> <li>Unpatented</li> <li>Vacated</li> </ul> </li> </ul>
---	---	---







Benewah County Aerial Imagery  
Township 47 North, Range 04 West, Section 35

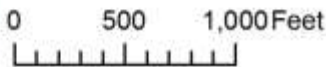

 **Kamiak  
Geospatial**

Projection: NAD 83 UTM11N  
(C) 2012 Kamiak Ridge, LLC  
& Benewah County



Boundary		Public Land Survey System	
	Benewah County		Section
	Coeur d'Alene Reservation		Parcel Boundary

# Benewah County Property Ownership

## Township 47 North, Range 04 West, Section 35

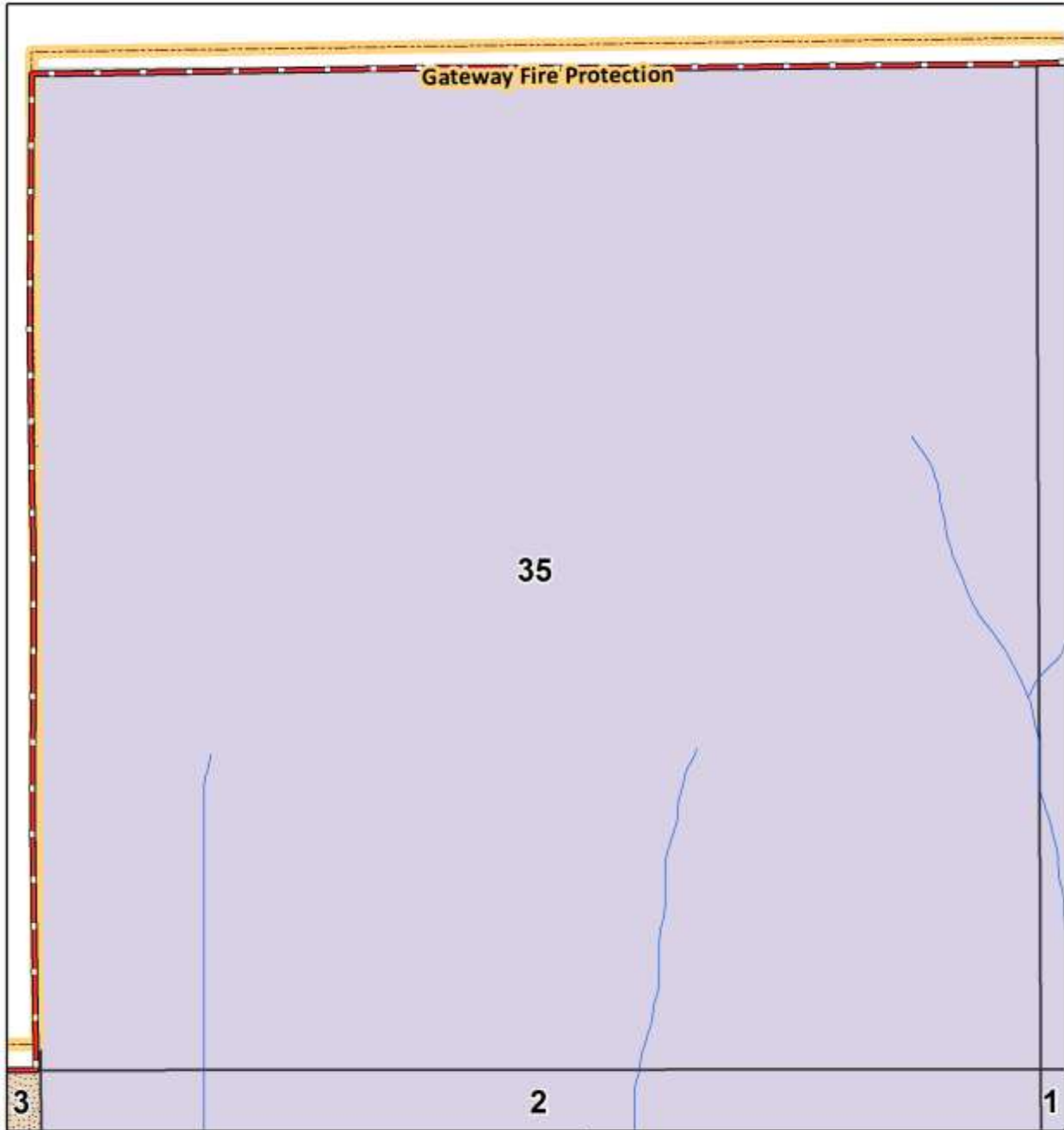

Projection: NAD 83 UTM11N  
 (C) 2012 Kamiak Ridge, LLC  
 & Benewah County

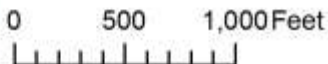

Land Ownership	
• Structures	Public
Transportation	County
U.S. Highway	City
State Highway	School District
Local Road	Plummer Hwy District
Seasonal Road	Forest Industry
Railroad	Private
Boundary	No Data
Benewah County	Unpatented
Coeur d'Alene Reservation	Vacated
Public Land Survey System	
Section	
Bureau of Land Management	
US Forest Service	
Bureau of Indian Affairs	
Coeur d'Alene Tribe	
Federal (TAP)	
Idaho Department of Lands	
Idaho Transportation Dept.	
Idaho Fish and Game	
Idaho Parks & Rec	

# Benewah County Aerial Imagery



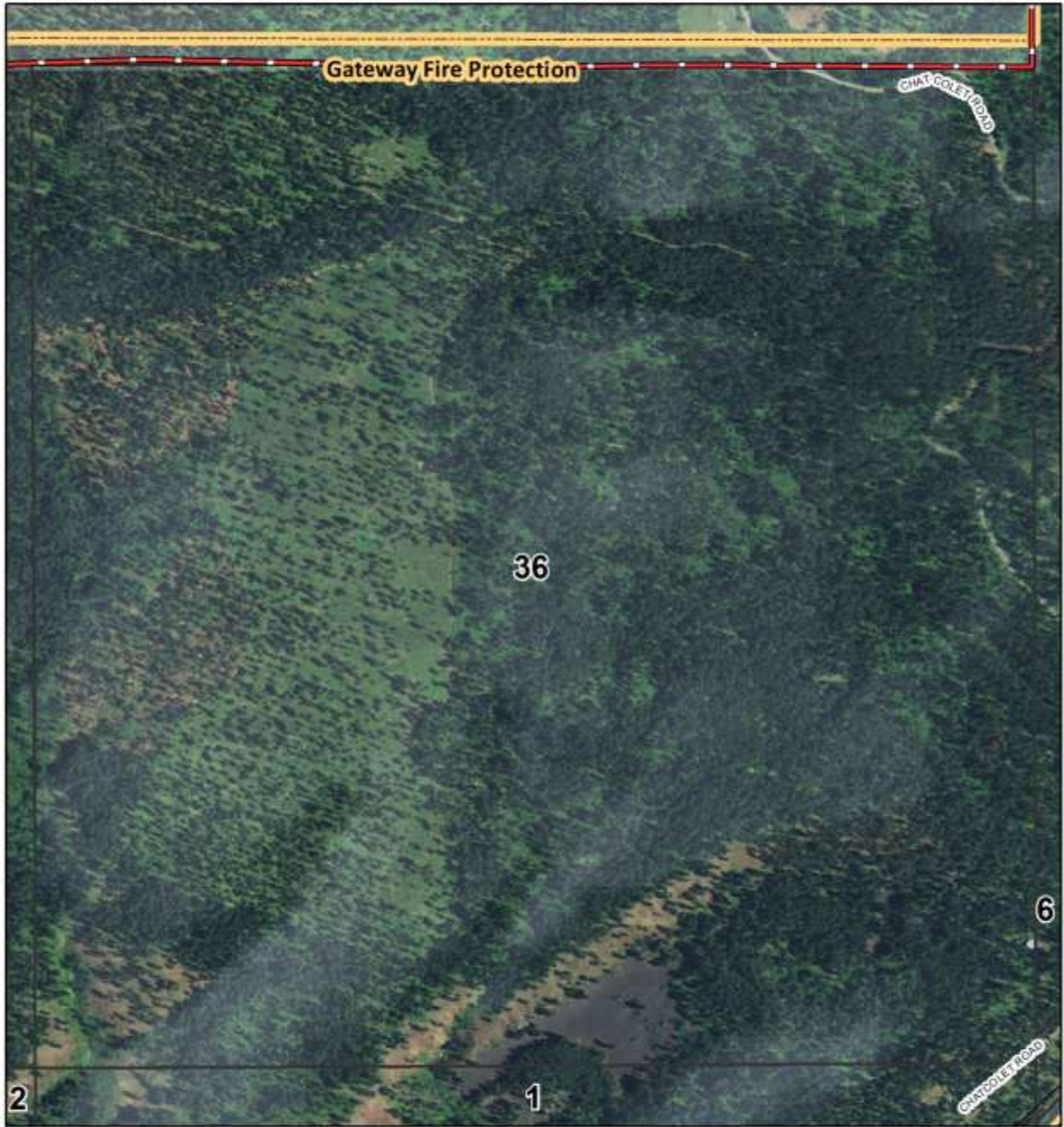

## Township 47 North, Range 04 West, Section 36

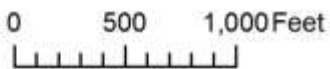

 **Kamiak Geospatial**

Projection: NAD 83 UTM11N  
(C) 2012 Kamiak Ridge, LLC  
& Benewah County



Boundary		Public Land Survey System	
	Benewah County		Section
	Coeur d'Alene Reservation		Parcel Boundary

# Benewah County Property Ownership

## Township 47 North, Range 04 West, Section 36

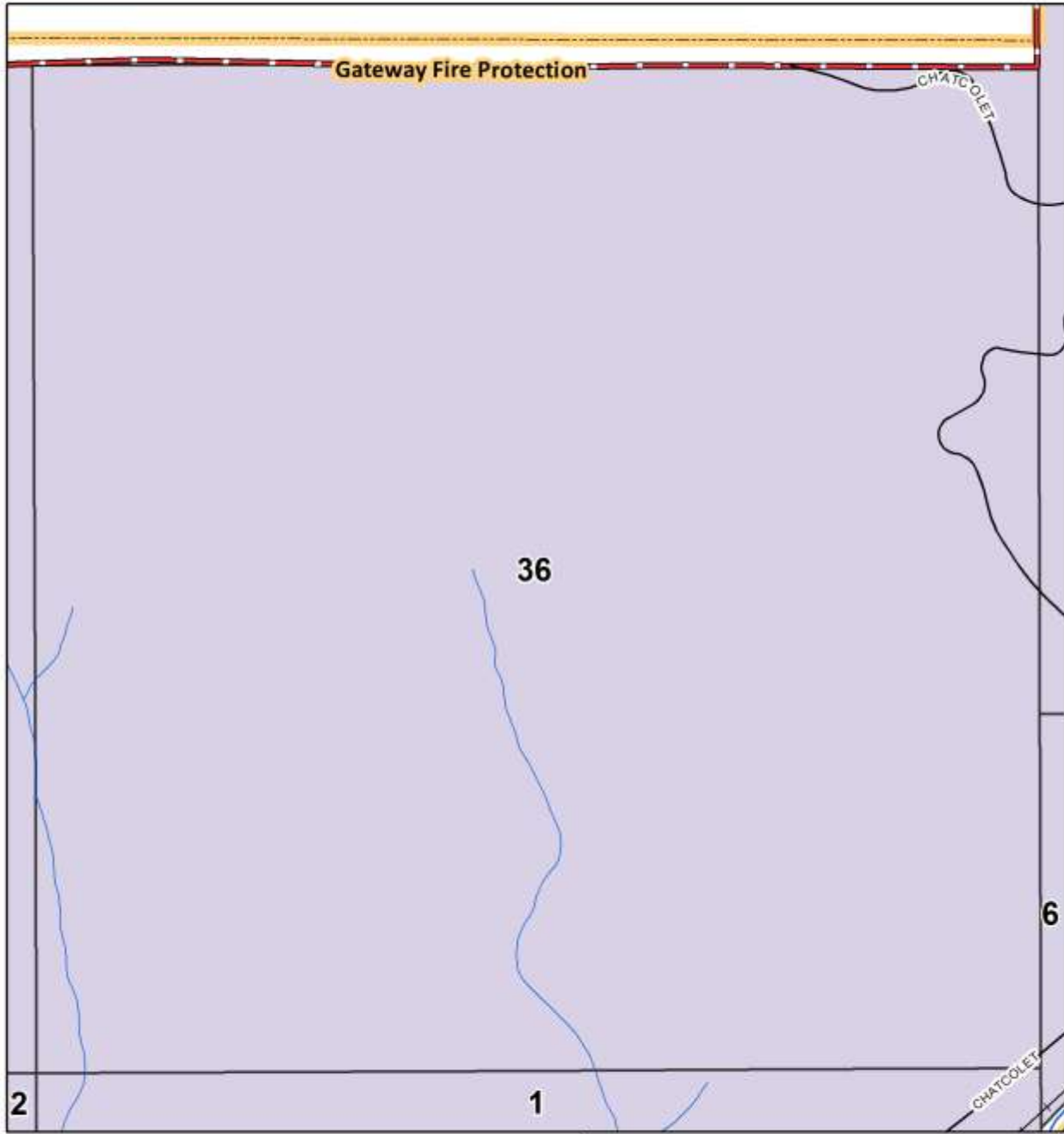

Projection: NAD 83 UTM11N  
 (C) 2012 Kamiak Ridge, LLC  
 & Benewah County



0 500 1,000 Feet



Transportation		Land Ownership	
	U.S. Highway		Bureau of Land Management
	State Highway		US Forest Service
	Local Road		Bureau of Indian Affairs
	Seasonal Road		Coeur d'Alene Tribe
	Railroad		Federal (TAP)
	Boundary		Idaho Department of Lands
	Benewah County		Idaho Transportation Dept.
	Coeur d'Alene Reservation		Idaho Fish and Game
	Public Land Survey System		Idaho Parks & Rec
	Section		Public
			County
			City
			School District
			Plummer Hwy District
			Forest Industry
			Private
			No Data
			Unpatented
			Vacated